

# Specification

Prepared	Checked	Approved

Accepted	Confirmed	Approved

**UL** **CE** **RoHS** **COB** **LED Strip** **DC 24V** **IP 67** **3** Years

**Model:** ☉ RM1214MD-V1

10000\*12mm, 448 chips per meter, IP67 silicone sleeve for constant current 24V flexible sauna light strip (white light 8W/m)

**Picture:**



**Features:**

- ☉ Super high-temperature resistant material, with the maximum operating temperature up to 125°C;
- ☉ Imported high-hermeticity eco-friendly silicone rubber, IP67 waterproof rating;
- ☉ IC constant current solution, single-ended power supply can be cascaded for up to 10 meters.

**Application:**

- ☉ The product is mainly used in high-temperature and high-humidity places such as saunas, for applications like main lighting, auxiliary lighting, and decorative lighting.

**Warranty:**

- ☉ 3 years or 13,000 hours, whichever comes first.

**Optical and Electrical Parameters:**

P/N	LED Color	CCT (K)	WL (nm)	CRI	SDCM	Beam Angle(°)	Luminous Flux (lm/m)	Luminous Efficacy (lm/w)	Working voltage (VDC)	Working current(mA)		Power (w)	
										1m[3 9.37 in]	10m [393.7 in]	1m[3 9.37 in]	10m [393.7 in]
RM1214MD-V1	white	2700	≥90	≤5	110	570	71	24	333	3208	8	77	
RM1214MD-V1	white	3000	≥90	≤5	110	630	78	24	333	3208	8	77	
RM1214MD-V1	white	4000	≥90	≤5	110	670	83	24	333	3208	8	77	
RM1214MD-V1	white	6500	≥90	≤5	110	670	83	24	333	3208	8	77	

**Others:**

P/N	IP Grade	OperatingTemp		Storage Temp		Standard length		Max. cascading length		Chip Qty (pcs/m)	Weight	
		(°C)	(°F)	(°C)	(°F)	(m)	(inch)	(m)	(inch)		(g/m)	(lb/m)
RM1214MD-V1	IP67	-25~+125	-13~+257	-25~+70	-13~+158	10	393.7	10	393.7	448	70	0.1543

Notes:

- (1) Testing environment temperature: 25±2°C [77±3.6°F];
- (2) The actual data of each single product may differ from above typical data which are subject to change without prior notice;
- (3) Bending diameter ≥50mm, not suitable for channel letter.
- (4) The above "--" means the parameters are not required temporarily.

**Profile Drawings:**

Unit: mm[inch]

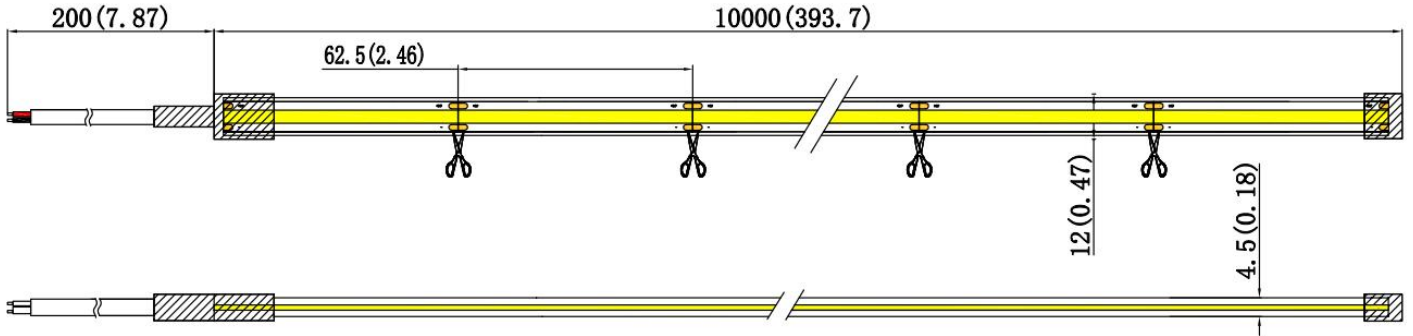

**Light Distribution/Iso-illuminance Diagram:**

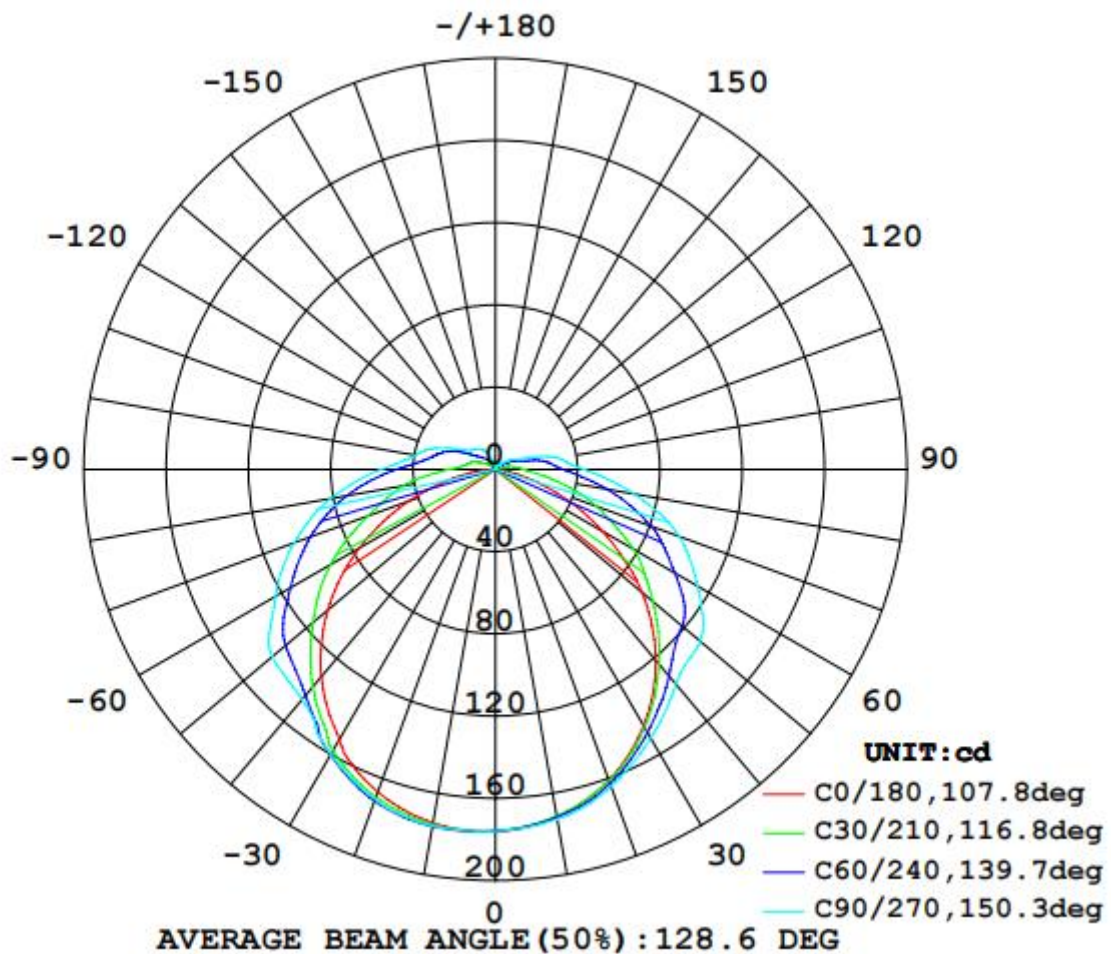

**Packaging Information:**

P/N	Qty (m/reel)	Qty (m/carton)	Total Qty (m)	Total weight		Outer carton size					
						length		width		height	
				(kg)	(lb)	(mm)	(inch)	(mm)	(inch)	(mm)	(inch)
RM1214MD -V1	10	180	180	15.2	33.51	430	16.93	340	13.39	448	17.64

Notes: Above qty and weight of packing is only for the packing shown in the picture, which might be different from other packing modes, thus for actual qty and weight please refer to actual samples.

**Packaging Diagram:**

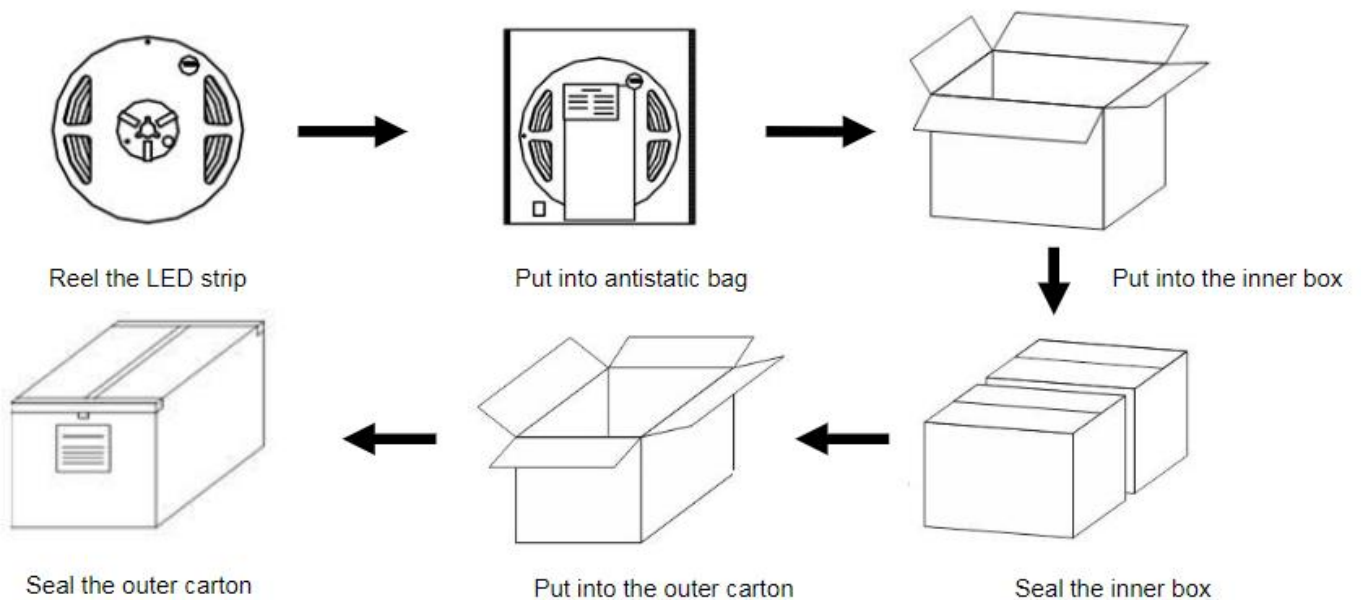

**Connection Instruction:**

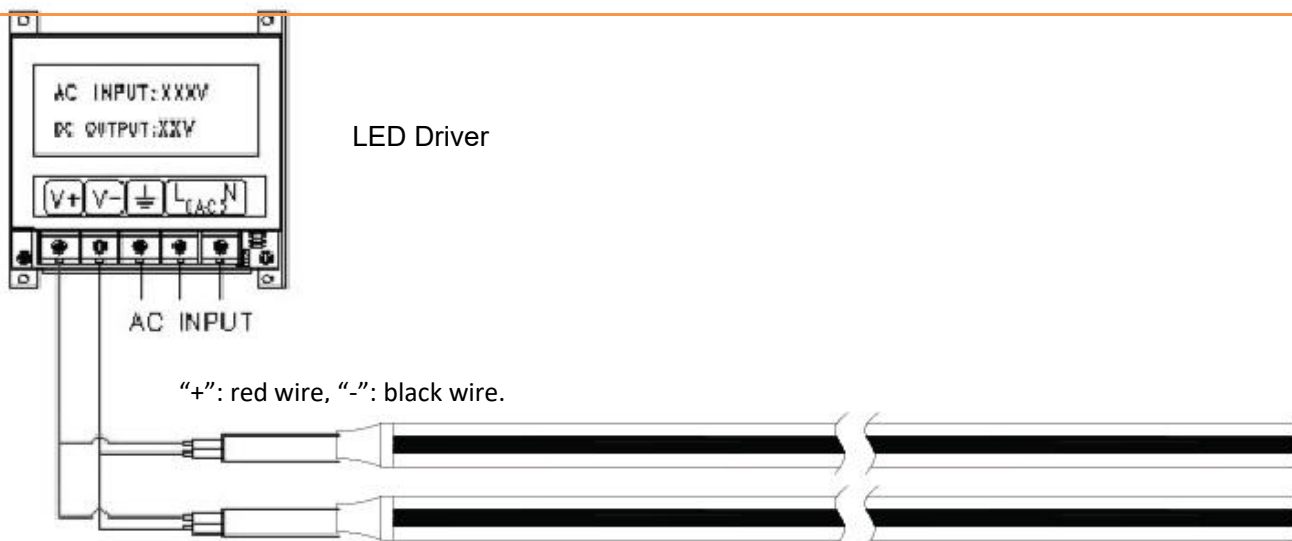

Notes: please make sure the "+" and "-" of the product's input are correctly connected to those of the power supply output.

Parts & Tools:

ProductParts Self-provided Tools

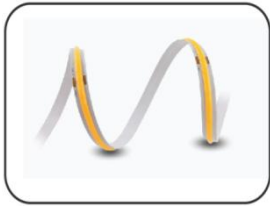

LED Strip



Electrical Drill & Drilling bit

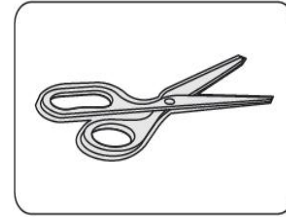

Scissors

Installation Steps& Cautions:

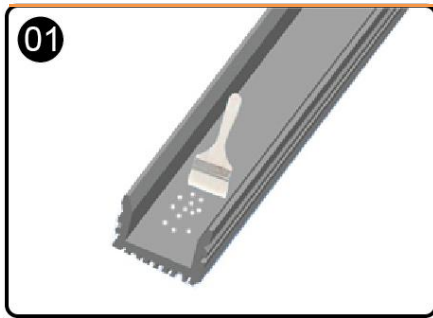

01 Clean the mounting surface

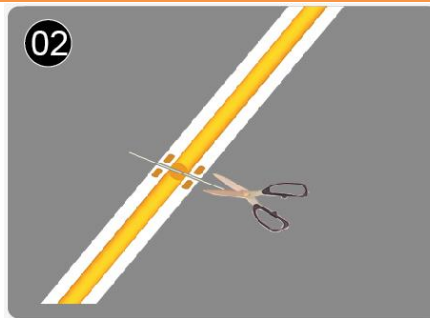

02 Calculate the needed length and cut off the extra length along cutting mark if necessary; if need to add wires, please weld them at the next location with printed mark.

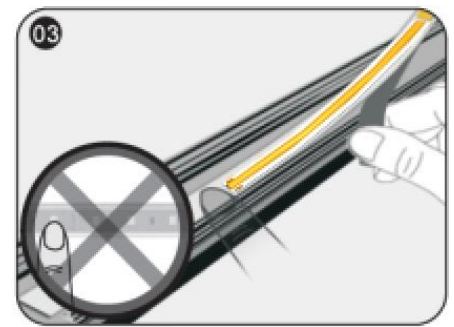

03 While sticking strips, peel off the release paper of the tape step by step. Don't peel off all release paper at one time to avoid getting your strip in a mess.

△Notes: No pressing the LED bead!

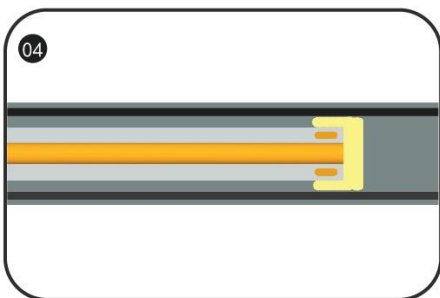

04 Stick Mylar tape to isolate the cutting position from the bottom of profile inner slot to avoid short-circuit;

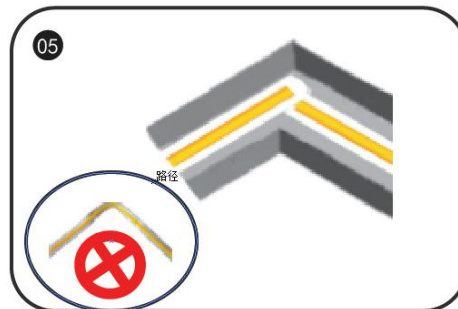

05 The installation at the corner is shown as the above figure.  
△ Notes: No bending it into right angle; No twisting it to stick on the mounting surface.

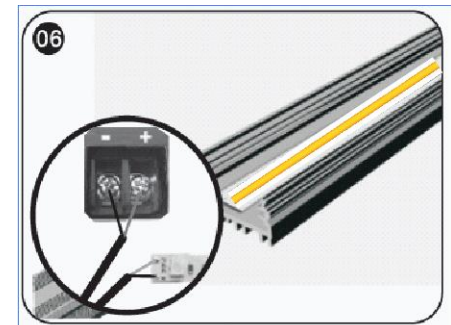

06 Connect strip wires to the output terminal of power supply, and dispose with waterproof, insulation, short-circuit and anti-corrosion protection at both the wire joints and the cut section of your strip (if any)

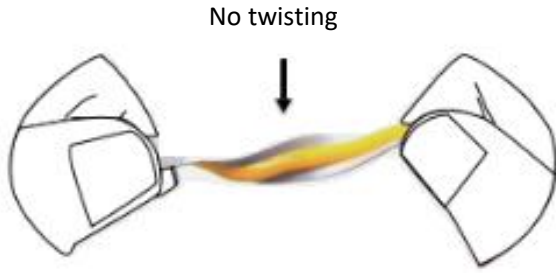

⊙ No twisting the strip

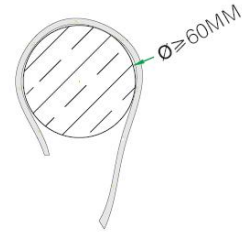
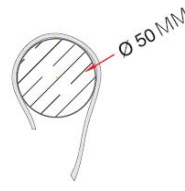

⊙ No winding an object with a diameter <5cm

**Troubleshooting:**

Malfunctions	Possible Causes	Solutions
All LEDs don't work	1. The power supply did not connect to power grid.	Power on
	2. No electricity due to short-circuit of external power supply.	Remove the malfunction caused by short-circuit, power on again.
	3. The wires of strips connect to power supply output reversely.	Check the connecting and ensure the wires are connected correctly.
Part of LEDs don't work	1. Part of power supplies do not have output.	Check the power supply system.
	2. Part of wires of strips have malfunction.	
	3. Particular modules connected reversely.	Correct connection
Brightness of LEDs is weak or uneven	1. Overloaded power supply;	Replace it with higher power supply
	2. The power loss of power circuit is huge or the power loss of each circuit existing big difference.	Ensure working voltage of strips is within $\pm 5\%$ V of rated voltage. (1. Shorten the length of wires between the first strip and power supply or replaced with wires with bigger diameter; 2. Ensure the cascading qty of string is less than or equal to the allowed maximum cascading qty, and each strip cascading qty is well-balanced.)
	3. Exceed in qty of strips in series	Lessen the cascading qty for strip and ensure the qty for each electrical circuit is within the maximum cascading qty.
LEDs are blinking	1. Poor contacted in the joints.	Find out and tackle malfunction immediately.
	2. Failures in power supply.	Replace power supply.

**Declaration:**

---

- ⊙ If the external flexible cable of light box is damaged, please replace it by its manufacturer or its service agent or qualified person to avoid a hazard.
- ⊙ The specific installation and cautions please refer to the user manual.
- ⊙ The given data in this specification is based on our standard product. There may be existed slight difference compared with actual products.
- ⊙ All Illustrations in this specification are for reference only.
- ⊙ This product is subject to change or modify without prior notice.
- ⊙ RISHANG OPTOELECTRONICS CO., LTD reserves the right of final explanation for this specification.

<End>

**Rishang Optoelectronics Co., Ltd**(stock code: 002654)

Add: 1st to 8th Floor, North Side, 701, Mason Building, No. 2519, Guangqiao Avenue,  
Fenghuang Community, Fenghuang Street, Guangming District, Shenzhen  
Guangdong Province, China

Tell: +86-755-36988588 E-mail: info@ledlamps.com.cn

Website: www.ledlamps.com.cn

Website



Official Account

