

PIR Motion Sensor Switch

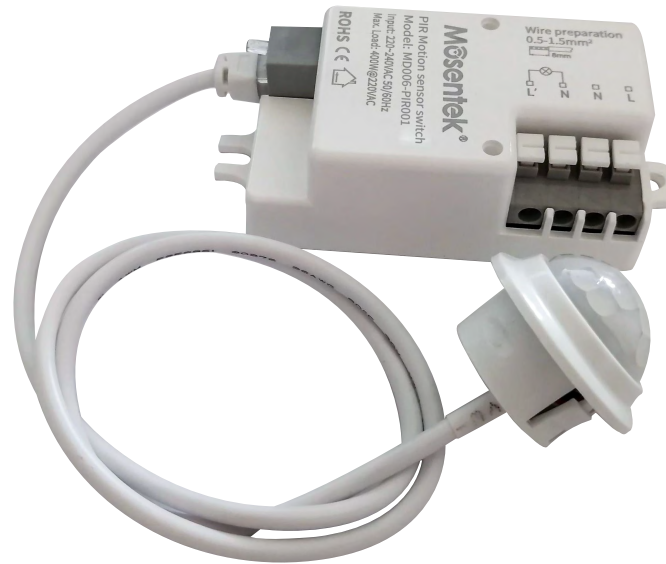

PRODUCT.: PIR Motion Sensor Switch

MODEL NO.: MD006-PIR001

SPEC NO.: _____

R & D DEPARTMENT		
WRITED BY	CHECKED	APPROVED

Features

- » 220-240VAC Input voltage.
- » Maximum loading up to 400W@220VAC.
- » Detachable antenna for flexible installation.
- » Remote control setting.
- » 5 years warranty.



Downlight

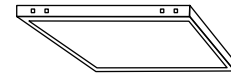

Panel light

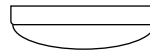

Ceiling light

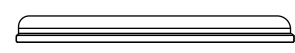

Linear light

Technical data

Operating voltage	220-240VAC 50/60Hz
Switching capacity	Max. 400W @220VAC
Stand-by power	<0.5W
Output	ON/OFF
Sensitivity	100%/75%/50%/25%
Hold time	5s/1min/3min/10min
Daylight threshold	Disable/10Lux/25Lux/50Lux
Mounting height	Max. 6m
Detection range	3-4m (25°C)
Detection Angle	100°
Operating temperature	-25°C - +50°C

Default setting: Sensitivity 100%, Hold time 5s, Daylight threshold 10Lux.

Mechanical structure

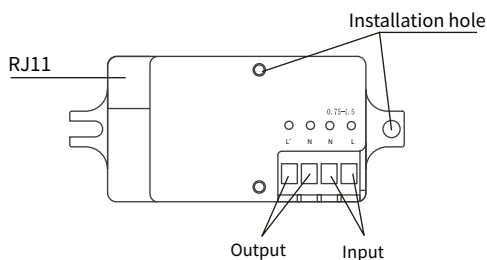

Wiring diagram

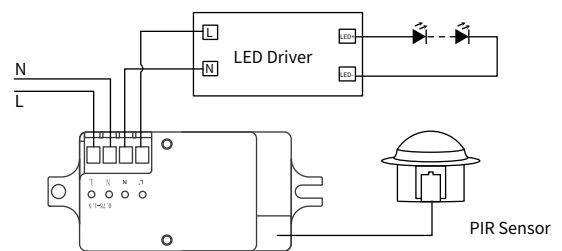

Dimension (Unit: mm)

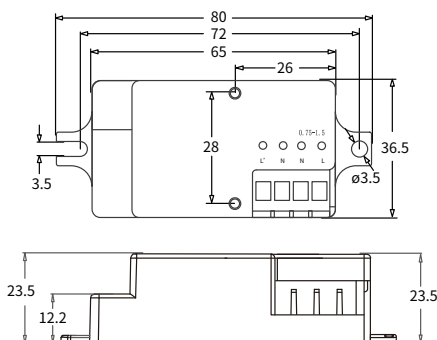

Attention: The switch is designed for connecting a single loading, it will affect the lifetime if connecting more than one loading.

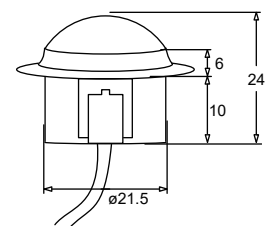
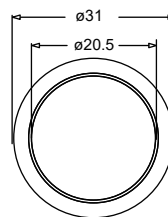

»»» Detection coverage

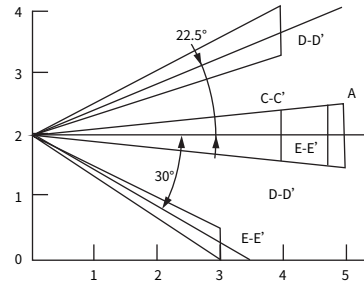
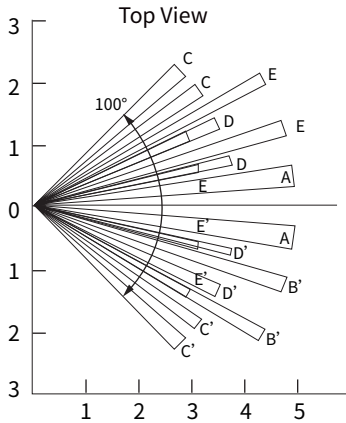

»»» Application

1. The daylight threshold is set to "10Lux/25Lux/50Lux."

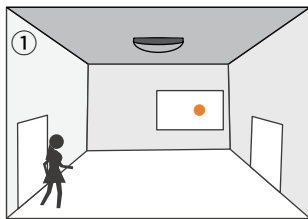

With sufficient daylight, even when motion detected, light remains OFF.

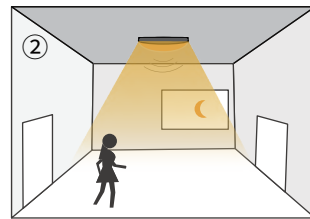

With insufficient ambient brightness, light dims to 100% when motion was detected.

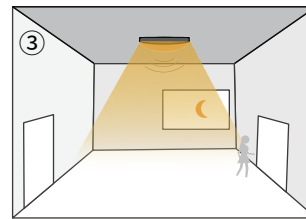

Light keeps on 100% within the holdtime.

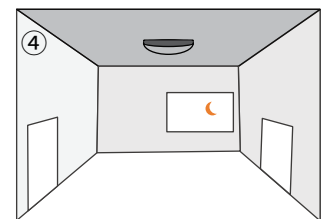

After the last detection and the preset hold time elapsed, light OFF.

2. The daylight threshold is set to "Disable".

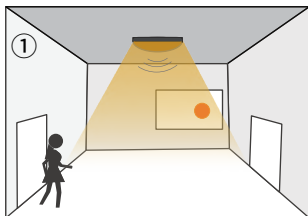

When motion is detected, the sensor will switch on the light to 100% brightness.

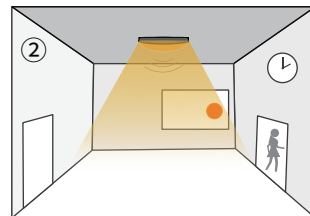

After people leave the detection area, light remains 100% brightness within hold time.

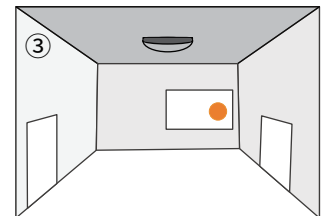

After the last detection and the present hold time elapsed, light OFF.

»»» Installation precautions

- » Please do not cover the PIR sensor by anything.
- » The fresnel lens should be install outside of the light fixture.
- » PIR sensor can not be installed near to the heat source location.
- » When the ambient temperature is up to 35°C, the detection range will be decreased.

Economic On/Off Version Remote Controller

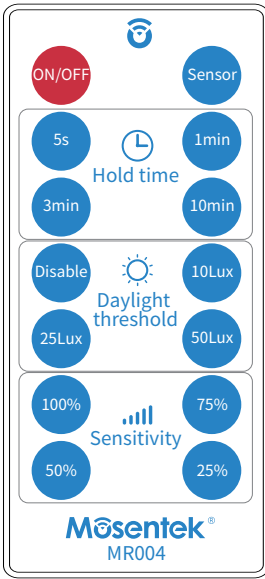

Key	Function
ON/OFF	Setting the light permanent ON or OFF without motion mode.
Sensor	Turn on Sensor mode
Hold time	The period of light keeping 100% brightness after moving objects leave the detection area.
Daylight threshold	Definition of the ambient brightness; only when the ambient brightness is lower than the preset specific lux amount, the sensor will work; when it's preset as "disable", the sensor will detects motion regardless the ambient brightness.
Sensitivity	In this area, movement will be detected and able to trigger the sensor. 100% detection area is also known as the strong sensitivity.
Remark	There is no Mosentek logo version for option

* Remote Setting Tips: When press any button, if the light is flickering one time, means the setting is successful.

Size (L*W*H): 86*40*7mm

CR2025 battery

