

# Specification

Prepared	Checked	Approved	Accepted	Confirmed	Approved

- UL
- CE
- RoHS
- 2835 SMD
- 60 LEDS/M
- LED Strip
- DC 12V
- IP 20
- 3 Years

**Model:** R0060TA-A-1

5000\*10mm, 300pcs 2835SMD LEDs, bare board, DC12V,  
LED flex strip

**Features:**

- ◎ Adopt 2835 SMD LED with high stability
- ◎ Specific colors make meat more vibrant
- ◎ Length can be cropped
- ◎ Safety Voltage, 12V, can be cut at the printed mark;

**Applications:**

- ◎ Suitable for lighting meat stalls

**Warranty:**

- ◎ 3 years or 13000 hours, whichever comes first.



**Optical and Electrical Parameters:**

P/N	LED Color	CCT (K) WL (nm)	CRI	SDCM	Beam Angle (°)	Luminous Flux (lm/m)	Luminous Efficacy (lm/W)	Working voltage (VDC)	Working current(mA)		Power(w)	
									1m[39.37in]	5m[196.8in]	1m[39.37in]	5m[196.8in]
R0060TA-A-1	white	2800-320 0K	90	--	≥115	900	62	12	1200	--	14.4	--

**Others:**

P/N	IP Grade	OperatingTemp		Storage Temp		Standard length		Max. cascading length		LED Qty (pcs/m)	Weight	
		(°C)	(°F)	(°C)	(°F)	(m)	(inch)	(m)	(inch)		(g/m)	(lb/m)
R0060TA-A-1	IP20	-25~ +60	-13~ +140	-25~ +70	-13~ +158	5	196.8	5	196.8	60	16	0.0352

Notes:

- (1) Testing environment temperature: 25±2°C [77±3.6°F];
- (2) The actual data of each single product may differ from above typical data which are subject to change without prior notice;
- (3)The above "--" means the parameters are not required temporarily.

Profile Drawings:

Unit: mm[inch]

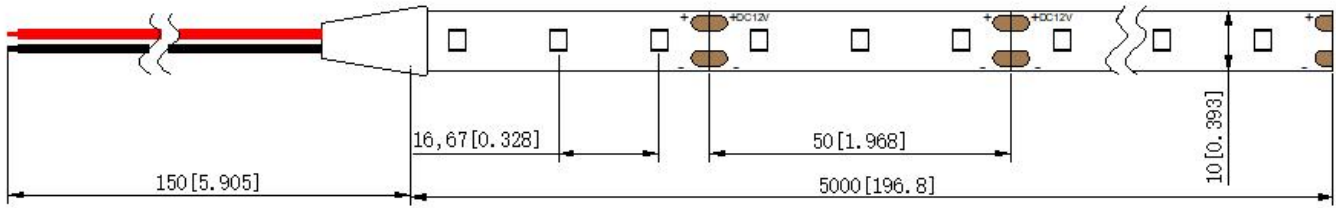

Packaging Information:

P/N	Qty (m/reel)	Qty (m/carton)	Total Qty (m)	Total weight		Outer carton size					
						length		width		height	
				(Kg)	(lb)	(mm)	(inch)	(mm)	(inch)	(mm)	(inch)
R0060TA-A-1	5	200	200	5	--	405	15.94	256	10.07	238	9.37

Notes: the actual packed quantity and weight might differ from the above data in other packaging ways. Thus please refer to the actual product for detailed information.

Packaging Diagram:

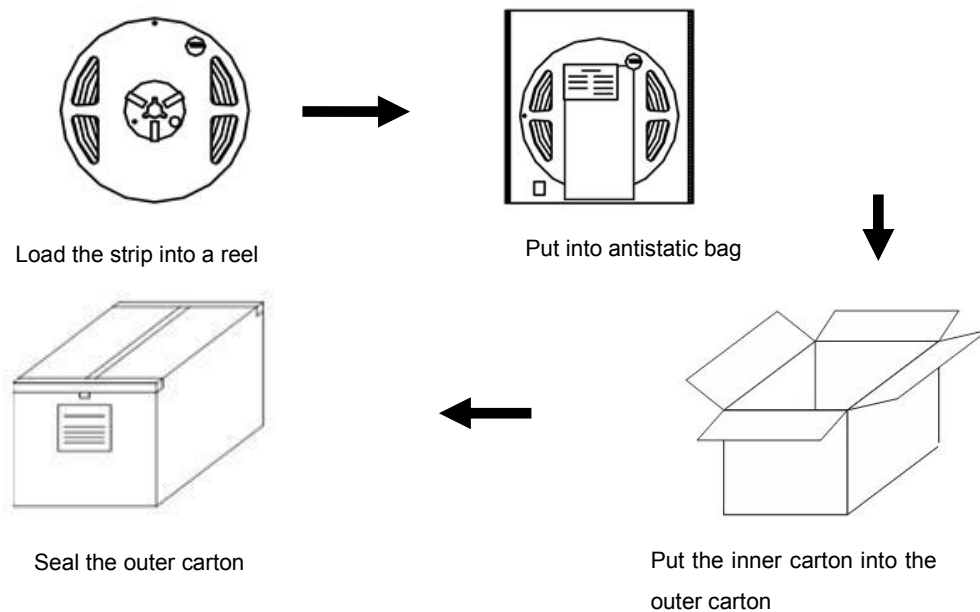

### Connection Instruction:

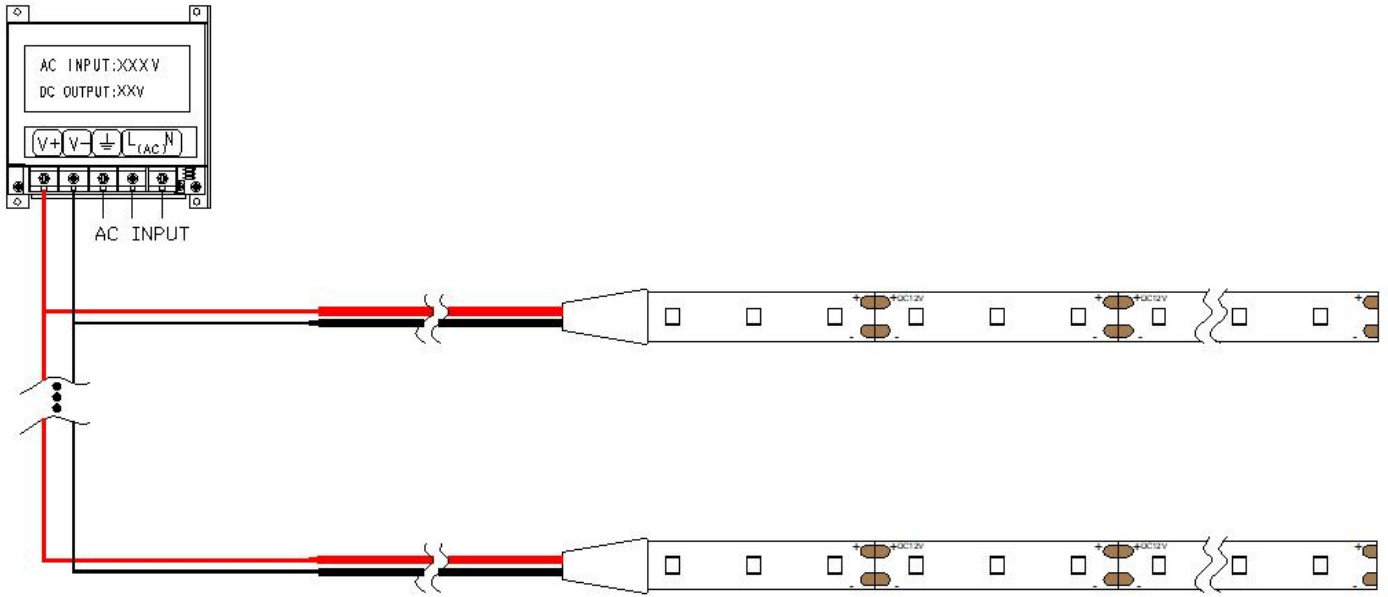

### Parts & Tools:

○ Product Spare Parts



LED Strip

○ Self-provided Tools



Electrical Drill & Drilling bit

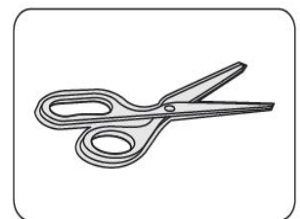

Scissors

**Installation Steps & Cautions:**

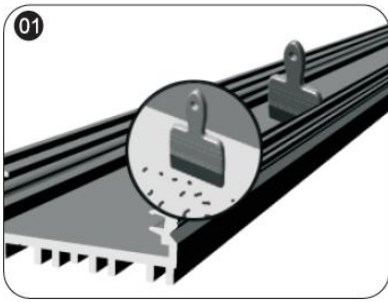

○ Make sure the mounting surface is clean before installation;

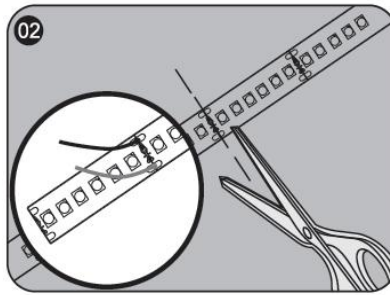

○ Calculate the needed length and cut off the extra length along cutting mark if necessary; if need to add wires, please weld them at the next location with printed mark;

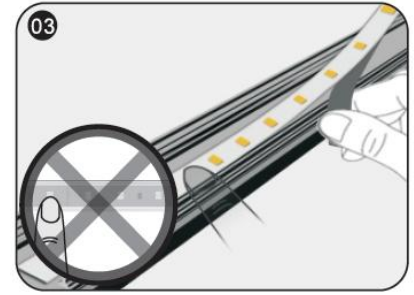

○ While sticking strips, peel off the release paper of the tape step by step. Don't peel off all release paper at a time to avoid getting your strip in a mess.

△Notes: No pressing the bead!



○ Stick Mylar tape to isolate the cutting position from the bottom of profile inner slot to avoid short-circuit;

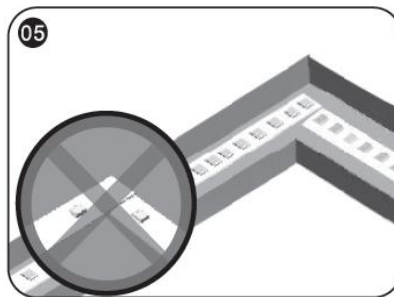

○ The installation at the corner is shown as the above figure.

△ Notes: No bending it into right angle; No twisting it to stick on the mounting surface.



○ Connect strip wires to CCT controller, and connect controller to the output terminal of power supply, and dispose with waterproof,insulation, short-circuit and anti-corrosion protection at both the wire joints and the cut section of your strip.

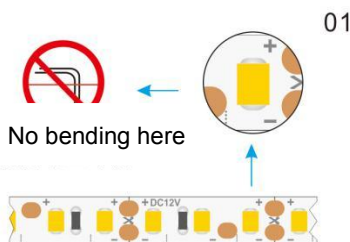

○ No bending the strip at the position of LED

No twisting

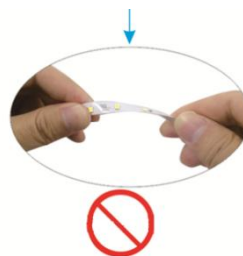

○ No twisting the strip

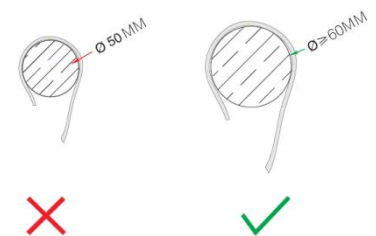

○ No winding an object with a diameter <5cm.

**Troubleshooting:**

Malfunctions	Possible Causes	Solutions
All LEDs don't work	1. The power supply did not connect to power grid.	Power on
	2. No electricity due to short-circuit of external power supply.	Remove the malfunction caused by short-circuit, power on again.
	3. The wires of strips connect to power supply output reversely.	Check the connecting and ensure the wires are connected correctly.
Part of LEDs don't work	1. Part of power supplies do not have output.	Check the power supply system.
	2. Part of wires of strips have malfunction.	
	3. Particular modules connected reversely.	Correct connection
LEDs are blinking	1. Signal line disconnected	Connecting signal line .

**Declaration:**

- ⊙ If the external flexible cable of light box is damaged, please replace it by its manufacturer or its service agent or qualifie person to avoid a hazard.
- ⊙ The specific installation and cautions please refer to the user manual.
- ⊙ The given data in this specification is based on our standard product. There may be existed slight difference compared with actual products.
- ⊙ All Illustrations in this specification are for reference only.
- ⊙ This product is subject to change or modify without prior notice.
- ⊙ RISHANG OPTOELECTRONICS CO., LTD. reserves the right of final explanation for this specification.

<End>

**Rishang Optoelectronics Co., Ltd.**(stock code: 002654)

Add: Block 2, Hongfa jiateli High-Tech. Park, Tangtou Ave., Shiyan, Bao'an, Shenzhen Guang Dong, 518108, China.

Tel: +86-755-36988588 E-mail: [info@ledlamps.com.cn](mailto:info@ledlamps.com.cn)

Website: [www.ledlamps.com.cn](http://www.ledlamps.com.cn)



Website



WeChat Account