

# SPECIFICATION

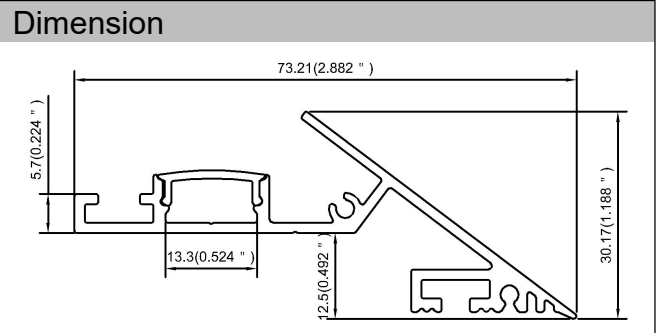

Specification	
Aluminum Profile	6063-T5
Diffuser	PC diffused cover / PMMA semi-clear cover
Length	2000mm / 2500mm / 3000mm
Weight	0.702kg/m
Max LED Strip Width	13mm
Max Power	15W/m
Beam angle	100°
Finish	Silver / Black anodized , Powder coated white / black or other colors
Installation	Surface

## Accessories

End Cap With Hole(Metal)	End Cap Without Hole(Metal)	LED Strip	180° Connector(Metal)
90° Connector(Metal)			

# SPECIFICATION

## Steps of Installation

1. Stick the LED strip

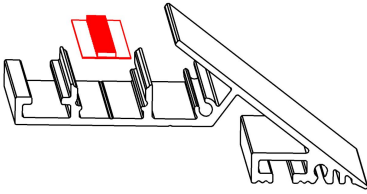

2. Press the diffused cover

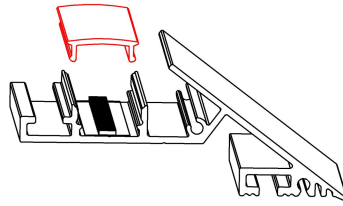

3. Lock the end caps with screws

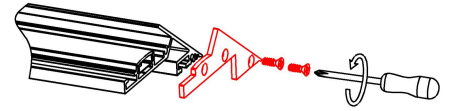

4. Insert the fixture to position

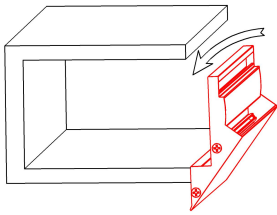

5. Already in place

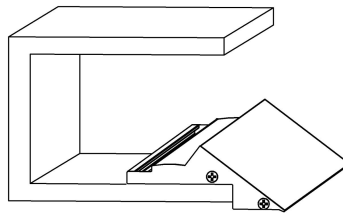

6. Fix the fixture to the drywall with screw

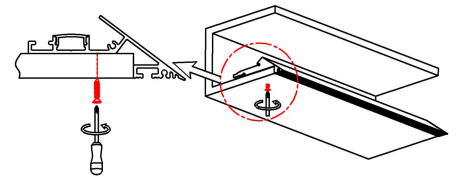

7. Plaster on the fixture & drywall

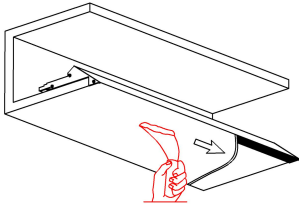

8. Painting on the fixture & drywall

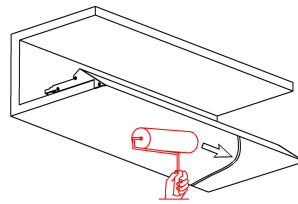

9. Installation completed

