

50W RF CCT LED Driver(constant voltage)

09.09CVT.04017



Important: Read All Instructions Prior to Installation

Function introduction

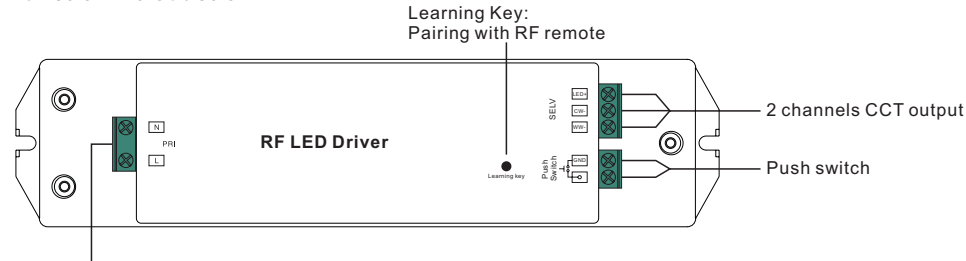

AC 200-240V input

Product Data

Output	DC Voltage	12V DC	24V DC
	Max. Current		Max. 4.16A/ch, ch1+ch2=4.16A
Rated Power		max. 50W	
Input	Voltage Range	200-240V AC	
	Frequency	50/60Hz	
	Power Factor (Typ.)	> 0.9	
	Efficiency (Typ.)	85% @ 230VAC	88% @ 230VAC
	Input Current	0.27A @ 230VAC	
Protection	Short Circuit	Yes	
	Over Current	Yes	
	Over Temperature	Yes	
Environment	Working Temp.	-20°C ~ +45°C	
	Max. Case Temp.	85°C	
	Working Humidity	10% ~ 95% RH non-condensing	
	Storage Temp. & Humidity	-40°C ~ +80°C, 10% ~ 95% RH	
Safety&EMC	Safety Standards	EN61347-1, EN61347-2-13	
	Withstand Voltage	I/P-O/P: 3.75KVAC	
	EMC Emission	En55015, EN61000-3-2, EN61000-3-3	
	EMC Immunity	En61547, EN61000-4-2,3,4,5,6,8,11, surge immunity Line-Line 1KV	

Others	MTBF	193.6K hrs min. @ 230VAC at full load and 25°C ambient temperature
	Dimension	210*50*32mm (L*W*H)

- Dimmable LED driver with RF control
- Max. output power 50W total
- 2 channels 12/24V DC constant voltage output
- Class II power supply, full isolated plastic case
- High power factor and efficiency
- To switch and dim CCT color LED lighting
- Compatible with a variety of CCT color RF remotes
- IP20 rating
- Suitable for indoor LED lighting applications
- Radio Frequency : 868/869.5/916.5/434mhz
- 3 years warranty

Safety & Warnings

- DO NOT install with power applied to device.
- DO NOT expose the device to moisture.

Wiring Diagram

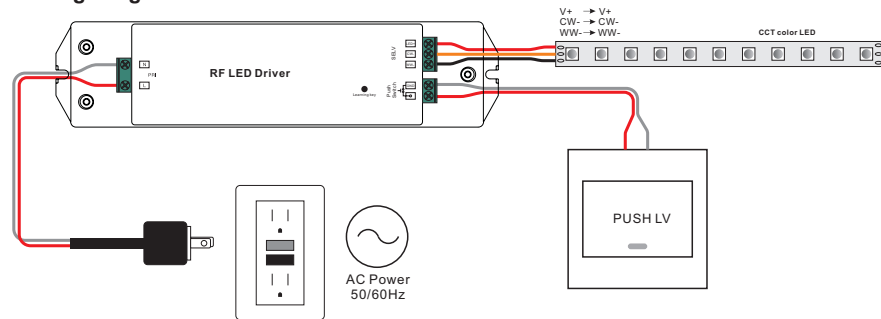

If you use multiple receivers, you have two choices:

Option 1: have all the receivers in the same zone, like zone 1

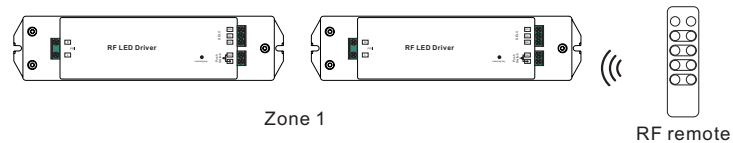

Option 2: have each receiver in a different zone, like zone 1, 2, 3 or 4

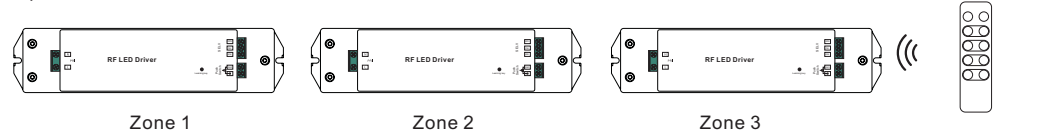

Operation

Do wiring according to connection diagram.

Pair to RF sender with learning key:

1. Connect and wire up the RF receiver correctly, power on.
2. Turn on the remote, click the "Learning Key" button on receiver, immediately click a zone number to pair the

receiver to the specified zone if the remote is a multi-zone controller (if it is a single zone remote, this step is unnecessary), then touch the color wheel or slider bar on the remote (if the remote does not have color wheel or slider bar, click or touch any keys), the connected led light on receiver flickers twice, which means well paired.

Note: one receiver can be paired with max 8 remote controls.

Pairing to RF sender without learning key:

1. Pairing to RF remotes which have color wheel: power off and power on the receiver → turn on the remote, then click a zone number twice and press and hold it continuously and quickly within 10 seconds → LED light connected with the receiver will flash to indicate successful pairing to the selected zone.
2. Pairing to multi-zone RF touch panels which have color wheel: power off and power on the receiver → turn on the panel, then click a zone number three times and press and hold it continuously and quickly within 10 seconds → LED light connected with the receiver will flash to indicate successful pairing to the selected zone.

Note: RF remotes without color wheel, single zone RF touch panels with color wheel, and RF touch panels without color wheel do not have this function.

Delete pairing with learning key :

1. Wire up the RF receiver correctly, power on
2. Hold down the " Learning Key" button on receiver for over 3 seconds until the connected led light on receiver flickers twice, which means well deleted.

Delete pairing without learning key and RF senders:

Power off and power on the receiver for 5 times continuously, the connected LED light will flash to indicate all pairing information is deleted successfully.

Delete pairing via RF sender without learning key:

1. Delete pairing of RF remotes that have color wheel: while the receiver has already paired to a remote that has color wheel, power off and power on the receiver → press and hold down all ON/OFF button on the remote until LED light connected with the receiver flashes → the pairing is deleted successfully
2. Delete pairing of single zone RF touch panels that have color wheel : while the receiver has already paired to a touch panel that has color wheel, power off and power on the receiver → press and hold down all ON/OFF button on the touch panel until LED light connected with the receiver flashes → the pairing is deleted successfully.

Note: RF remotes without color wheel, multi-zone RF touch panels with color wheel, and RF wall panels without color wheel do not have this function.

How to stop running mode of single color LED light caused by RGBW sender interference:

1. When pairing single color LED light to a single color remote, it might be interfered and paired by nearby RGBW senders, which might control the single color light into running mode. The running mode can not be stopped by the paired single color remote or by delete pairing.
2. Then we need a remote or wall panel that has color wheel, and pair the remote or wall panel to the receiver via above mentioned pairing method 2 (Pairing to RF sender without learning key), then touch the color wheel to stop the running mode.
3. Then delete pairing and pair the receiver to the single color remote again, it can be controlled by the remote again.

PUSH DIM:

While connected with PUSH LV, click the button to switch ON/OFF lights. Press and hold down the button to increase/decrease light intensity.